



TP-FM02-07

CHARM™ I/O Baseplate adapter with 2 x DMCV18 connectors

Description :

The **TP-FM02-07** adapter panel is used to connect a FIRELEC interface to the Emerson CHARM™ I/O baseplate (DeltaV™ S-series) using two DMCV 18 pin male connectors.

The **TP-FM02-07** is screwed directly on the CHARM™ I/O baseplate.

The connection to the FIRELEC interface is done using two shielded cables, with a DFMC 18 pin female connector at one end, and labeled flying wires or a suitable connector matching with the FIRELEC interface at the other end.

Product options :

Option -1 : *TP-FM02-07-1*, Standard version

Option -VSH : Conformal coating (Tropicalization)

Technical Specifications :

Dimensions :

Length : 187 mm

Width : 43 mm (54 mm with ID label)

Height : 40 mm

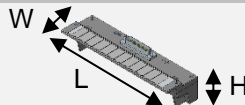

Weight :

145 g (165 g with labelling plate LB-11696-1)

Shield connection :

Directly using the dedicated screws of the CHARM™ I/O Baseplate

Temperature range :

Operating : -10°C to 70°C

Storage : -10°C to 70°C

Max Voltage :

250Vac

Max Current :

2A

Humidity :

Up to 90% (no condensation)

Mounting on the CHARM I/O baseplate :

Secured by 24 screws of the CHARM™ I/O Baseplate

(Screw 2 and 4 for each of the 12 channels)

Connection with the FIRELEC interface :

Two DMCV 18 pin male connectors.



TP-FM02-07-1



TP-FM02-07-1 + LB-11696-1

Pin Assignment :

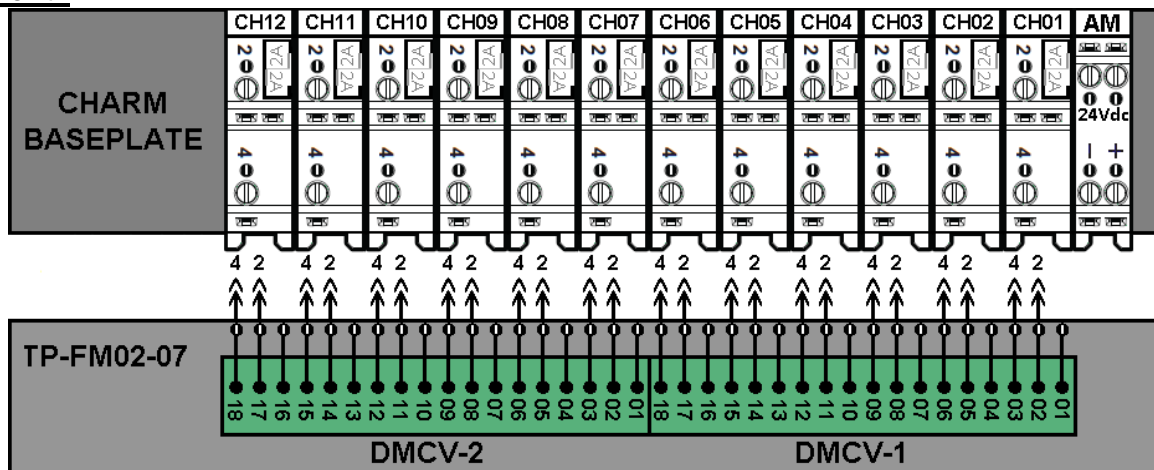





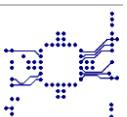
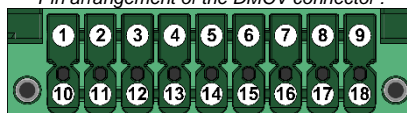

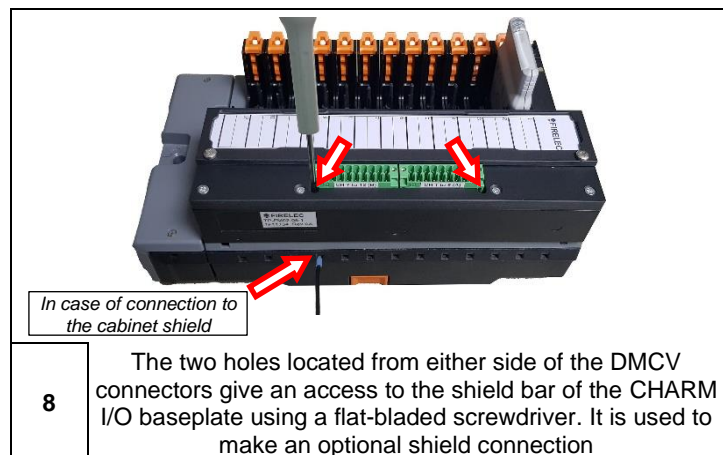
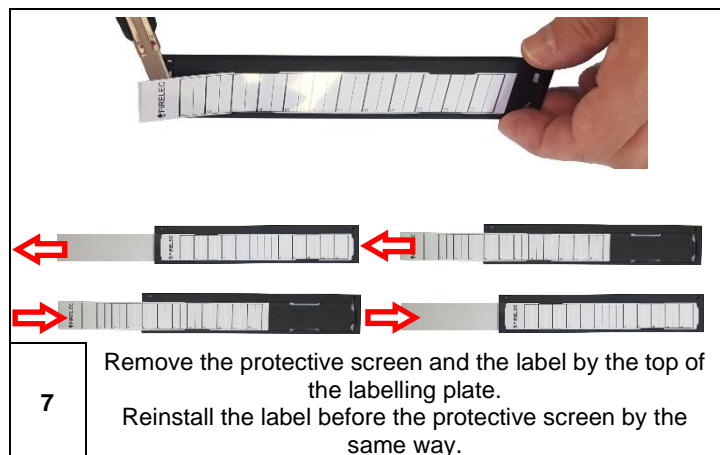
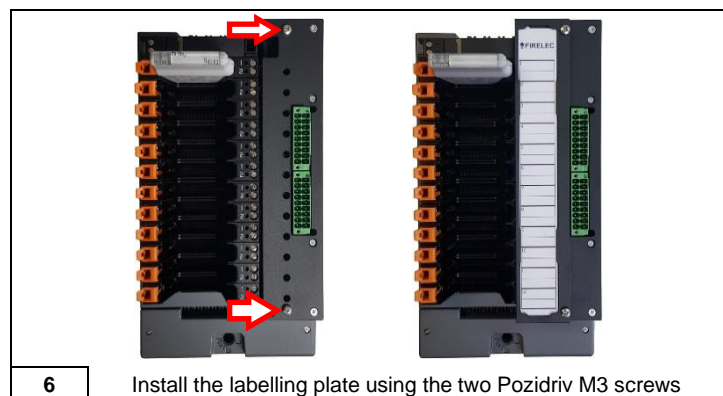
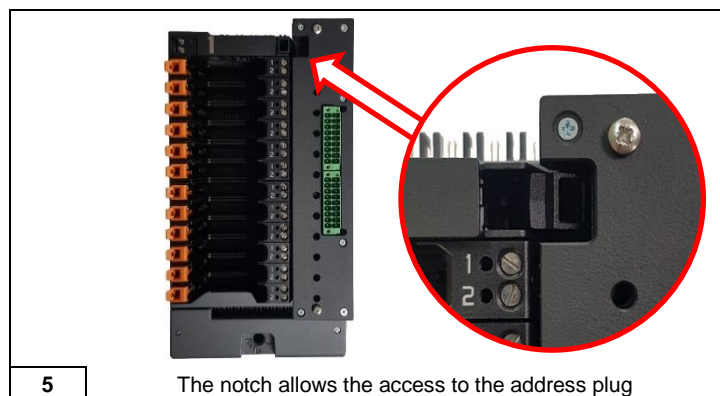
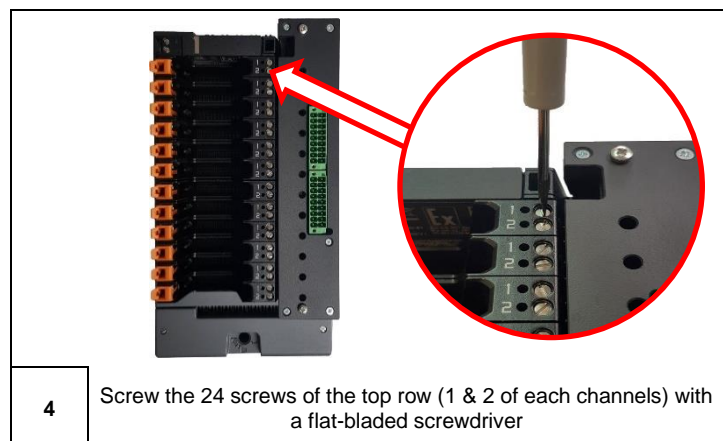
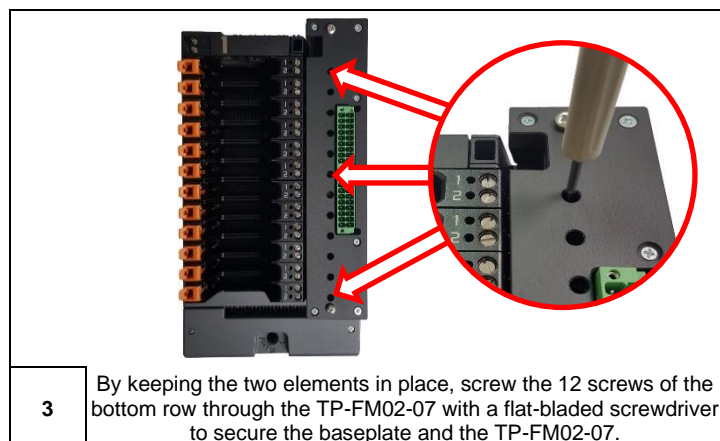
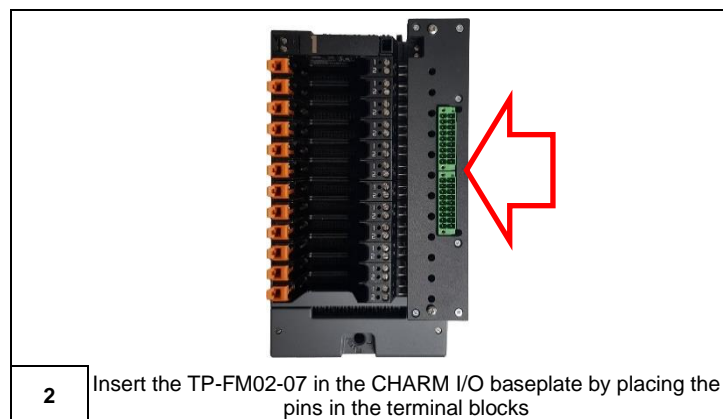
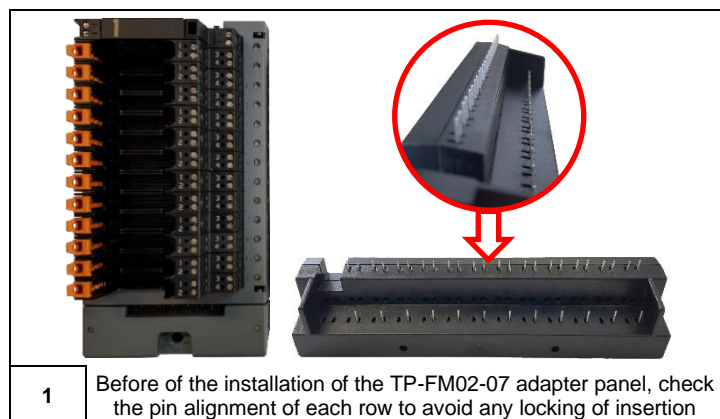













	CH12	CH11	CH10	CH09	CH08	CH07	CH06	CH05	CH04	CH03	CH02	CH01	AM
	J2 (second DMCV18 for channels 07 to 12)						J1 (first DMCV18 for channels 01 to 06)						
CHARM™	4	2	4	2	4	2	4	2	4	2	4	2	- +
DMCV pin	18	17	15	14	12	11	09	08	06	05	03	02	NC NC

Pin arrangement of the DMCV connector :



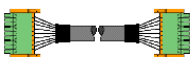

Compatibility :

CODE	Signal	Signal description	CHARM TB	CHARM module	TP-FM02	Interfacing cable	FIRELEC FTA Reference
CM-DI35	DI	120Vac Isolated Dry contact (Low input current - 2mA) (With injected power TB)	SE4512	SE4301T03	 TP-FM02-07-1	  2 x CBL-1754 Option (-1)	 INT-2DMCV18/363
CM-DI36	DI	120Vac Isolated Plus Dry contact or 2W sensor - (High input current - 10mA) (With injected power TB)	SE4512	SE4301T05	 TP-FM02-07-1	  2 x CBL-1754 Option (-1)	 INT-2DMCV18/363
CM-DI37	DI	230Vac Isolated Dry contact (Low input current - 1mA) (With injected power TB)	SE4512	SE4301T04	 TP-FM02-07-1	  2 x CBL-1754 Option (-1)	 INT-2DMCV18/363
CM-DO16	DO	Isolated (With injected power TB) - 1A continuous (Fuse protection 2A)	SE4502	SE4302T02	 TP-FM02-07-1	  2 x CBL-1754 Option (-1)	 INT-2DMCV18/363
CM-DO14	DO	500mA - 230Vac - Isolated (With injected power TB)	SE4502	SE4302T03	 TP-FM02-07-1	  2 x CBL-1754 Option (-1)	 INT-2DMCV18/363

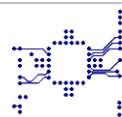

CM-DO15	DO	24Vdc Power Charm 24Vdc distribution with 1A max	SE4502	SE4302T05	 TP-FM02-07-1	 2 x CBL-1754 Option (-1)	 INT-2DMCV18/363
---------	----	--	--------	-----------	---	--	--

